

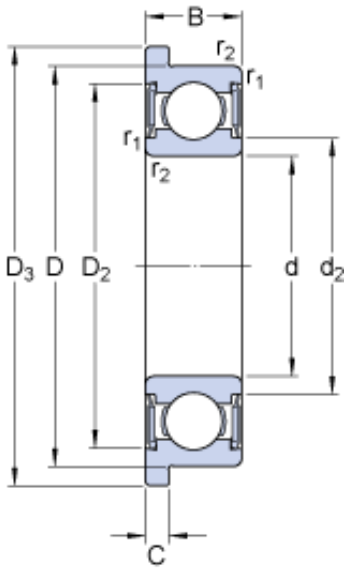

# Xili Bearing Co., Ltd

## 5 mm x 14 mm x 5 mm SKF W 605 R-2RS1 deep groove ball bearings

Bearing No. W 605 R-2RS1



W 605 R-2RS1 Bearing 2D drawings and 3D CAD models

Size	14x5x5 mm
Bore Diameter	14 mm
Outer Diameter	5 mm
Width	5 mm
d	5 mm
D	14 mm
B	5 mm
d <sub>2</sub>	7.119 mm
D <sub>2</sub>	12.2 mm
D <sub>3</sub>	16 mm
C	1 mm
r <sub>1,2</sub> - min.	0.2 mm
d <sub>a</sub> - min.	6.4 mm
r <sub>a</sub> - max.	0.2 mm
Basic dynamic load rating - C	0.761 kN
Basic static load rating - C <sub>0</sub>	0.26 kN
Fatigue load limit - P <sub>u</sub>	0.011 kN
Limiting speed	30000 r/min
Calculation factor - k <sub>r</sub>	0.03
Calculation factor - f <sub>0</sub>	6.6
d <sub>2</sub>	6.9 mm
D <sub>2</sub>	12.2 mm
D <sub>3</sub>	16 mm
r <sub>1,2</sub> min.	0.2 mm



## Xili Bearing Co., Ltd

$d_a$ min.	6.6 mm
$d_a$ max.	6.8 mm
$r_a$ max.	0.2 mm
Basic dynamic load rating C	0.761 kN
Basic static load rating $C_0$	0.26 kN
Fatigue load limit $P_u$	0.011 kN
Calculation factor $k_r$	0.03
Calculation factor $f_0$	6.6
Mass bearing	0.0038 kg